



Victor Kelly Estate Agents

**246-250 King Street NEWTOWN, NSW
UNDER CONTRACT - RETAIL KING ST NEWTOWN**

Contact Cherie Kelly
0478680551

Two storey retail/commercial building located in the best position on King Street Newtown offering prime retail frontage within the active Newtown shopping/commercial precinct. Chemist Warehouse occupying the ground floor retail area and two commercial office suites on level 1, plus two concrete sealed car spaces are available at the rear, this property is an exceptional investment opportunity.

Type Retail

Land 412Square Metres

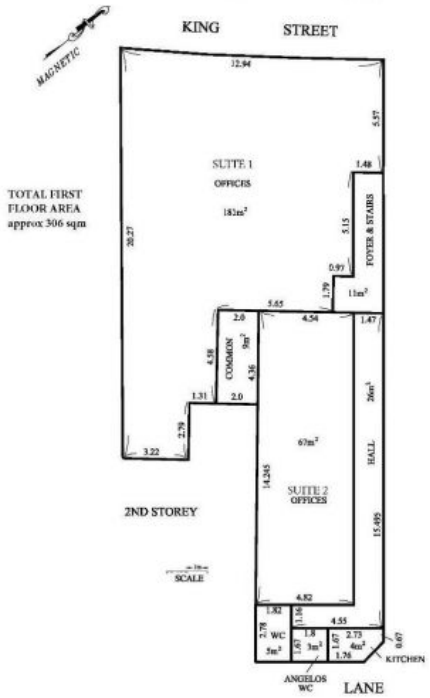
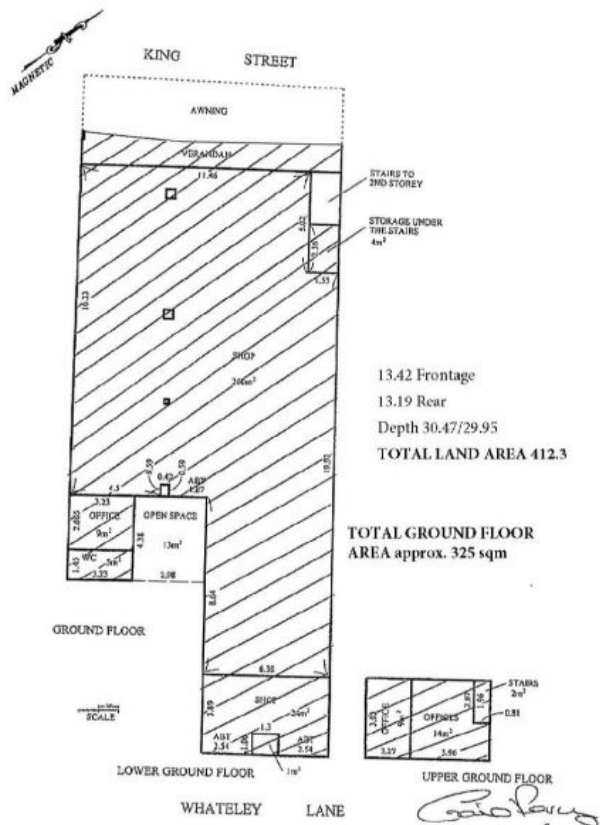

246-250 King Street NEWTOWN, NSW



Plans shown are only indicative of layout. Dimensions are approximate.