



**Victor Kelly Estate Agents**

**NEWTOWN, NSW**

**SUIT INVESTOR OR OWNER OCCUPIER**

**Contact** Victor Kelly  
0419212810

**UNDER CONTRACT**

A rare opportunity to acquire a prime commercial and residential property with dual income to add to your portfolio. This is an excellent mixed use building with valuable rear lane access and parking.

**Type** Retail

**GROUND FLOOR:** Consists of a retail shop and storeroom with kitchenette facilities.

**Land** 140Square Metres

**GROUND & FIRST FLOOR:** Consists of a self-contained split level 3.5 bedroom apartment with remote control roller door to the car port.

**NOTE DA APPROVED TO INCREASE BUILDING FLOOR SPACE.** Full property report available on request.

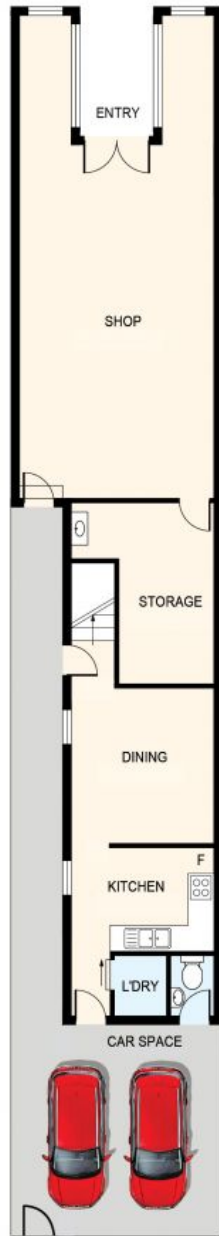

GATE  
GROUND FLOOR



FIRST FLOOR



DISCLAIMER: THIS IS FOR ILLUSTRATIVE PURPOSES ONLY. ALL DIMENSIONS ARE APPROXIMATE AND IT DOES NOT CONSTITUTE PART OF ANY LEGAL DOCUMENTS.

ADDRESS:

551C KING STREET, NEWTOWN

## NEWTOWN, NSW



Plans shown are only indicative of layout. Dimensions are approximate.